

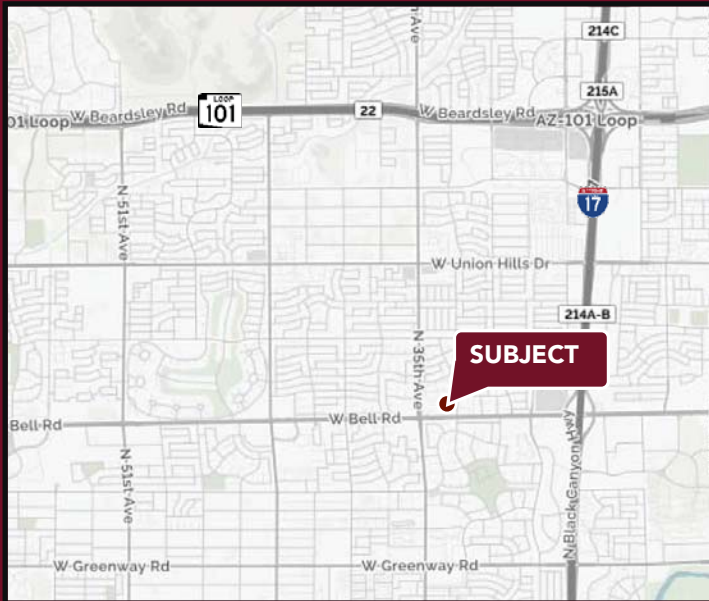

# BELL WEST

NORTHEAST CORNER OF 33RD AVE. & BELL RD., PHOENIX, AZ



## AVAILABILITY

- 797 SF
- (3) 1,400 SF

## FEATURES

- Monument Signage Available
- Less than one mile from 1-17 Freeway
- Adjacent to Safeway
- Strong Population

## NOTABLE TENANTS IN TRADE AREA

2017 Demographics	1 MILE	3 MILE	5 MILE
Estimated Population	17,634	140,026	327,482
Ave Household Income	\$59,743	\$65,316	\$68,604
Estimated Households	6,982	54,659	129,000



EXCLUSIVELY REPRESENTED BY

WWW.STRATEGICRETAILGROUP.COM



# STRATEGIC

ERIN SCHRAUTH  
602.792.5201  
erins@srgaz.com

KRISTINA REMON  
602.792.5202  
kristinar@srgaz.com

VANESSA RODRIGUEZ  
602.792.5203  
vanessar@srgaz.com

15169 N. Scottsdale Road Suite 330 Scottsdale, AZ 85254 602.778.3838(p) 602.778.3839(f)



# BELL WEST

NORTHEAST CORNER OF 33RD AVE. & BELL RD., PHOENIX, AZ



Information contained herein is believed to be accurate but is not warranted as to accuracy and may change or be updated without notice. Seller or landlord makes no representation as to the environmental condition of the property and recommends purchaser's or tenant's independent investigation.

EXCLUSIVELY REPRESENTED BY

WWW.STRATEGICRETAILGROUP.COM



## STRATEGIC

ERIN SCHRAUTH  
602.792.5201  
erins@srgaz.com

KRISTINA REMON  
602.792.5202  
kristinar@srgaz.com

VANESSA RODRIGUEZ  
602.792.5203  
vanessar@srgaz.com

15169 N. Scottsdale Road Suite 330 Scottsdale, AZ 85254 602.778.3838(p) 602.778.3839(f)

# EXPANDED PROFILE

2000-2010 Census, 2017 Estimates with 2022 Projections

Calculated using Weighted Block Centroid from Block Groups

Lat/Lon: 33.6397/-112.1300

RF5

W Bell Rd & N 33rd Ave Phoenix, AZ 85053		1 mi radius	3 mi radius	5 mi radius
<b>Population</b>				
Estimated Population (2017)		17,634	140,026	327,482
Projected Population (2022)		19,146	151,969	356,103
Census Population (2010)		16,774	133,928	310,756
Census Population (2000)		17,798	136,476	317,527
Projected Annual Growth (2017 to 2022)		1,512 1.7%	11,943 1.7%	28,621 1.7%
Historical Annual Growth (2010 to 2017)		860 0.7%	6,098 0.7%	16,726 0.8%
Historical Annual Growth (2000 to 2010)		-1,024 -0.6%	-2,548 -0.2%	-6,771 -0.2%
Estimated Population Density (2017)		5,614 <i>psm</i>	4,954 <i>psm</i>	4,171 <i>psm</i>
Trade Area Size		3.14 <i>sq mi</i>	28.27 <i>sq mi</i>	78.51 <i>sq mi</i>
<b>Households</b>				
Estimated Households (2017)		6,982	54,659	129,000
Projected Households (2022)		7,346	57,459	135,933
Census Households (2010)		6,524	51,521	120,444
Census Households (2000)		6,741	51,281	118,897
Estimated Households with Children (2017)		2,250 32.2%	17,611 32.2%	40,585 31.5%
Estimated Average Household Size (2017)		2.52	2.55	2.52
<b>Average Household Income</b>				
Estimated Average Household Income (2017)		\$59,743	\$65,316	\$68,604
Projected Average Household Income (2022)		\$72,229	\$79,417	\$84,262
Estimated Average Family Income (2017)		\$70,250	\$77,148	\$80,830
<b>Median Household Income</b>				
Estimated Median Household Income (2017)		\$56,152	\$58,092	\$60,438
Projected Median Household Income (2022)		\$66,556	\$68,540	\$71,129
Estimated Median Family Income (2017)		\$65,988	\$69,280	\$72,540
<b>Per Capita Income</b>				
Estimated Per Capita Income (2017)		\$23,686	\$25,534	\$27,089
Projected Per Capita Income (2022)		\$27,743	\$30,063	\$32,225
Estimated Per Capita Income 5 Year Growth		\$4,057 17.1%	\$4,529 17.7%	\$5,136 19.0%
Estimated Average Household Net Worth (2017)		\$481,124	\$593,668	\$652,335
<b>Daytime Demos (2017)</b>				
Total Businesses		547	4,165	12,792
Total Employees		5,277	48,296	145,254
Company Headquarter Businesses		4 0.7%	23 0.5%	64 0.5%
Company Headquarter Employees		401 7.6%	4,713 9.8%	11,029 7.6%
Employee Population per Business		9.6	11.6	11.4
Residential Population per Business		32.2	33.6	25.6

This report was produced using data from private and government sources deemed to be reliable. The information herein is provided without representation or warranty.

# EXPANDED PROFILE

2000-2010 Census, 2017 Estimates with 2022 Projections

Calculated using Weighted Block Centroid from Block Groups

Lat/Lon: 33.6397/-112.1300

RFS

W Bell Rd & N 33rd Ave Phoenix, AZ 85053		1 mi radius		3 mi radius		5 mi radius	
<b>Race &amp; Ethnicity</b>							
White (2017)		13,695	77.7%	105,997	75.7%	248,016	75.7%
Black or African American (2017)		847	4.8%	6,340	4.5%	15,484	4.7%
American Indian or Alaska Native (2017)		315	1.8%	2,092	1.5%	4,988	1.5%
Asian (2017)		512	2.9%	6,514	4.7%	15,164	4.6%
Hawaiian or Pacific Islander (2017)		22	0.1%	281	0.2%	619	0.2%
Other Race (2017)		1,513	8.6%	13,376	9.6%	30,661	9.4%
Two or More Races (2017)		729	4.1%	5,426	3.9%	12,549	3.8%
Not Hispanic or Latino Population (2017)		13,968	79.2%	109,113	77.9%	253,826	77.5%
Hispanic or Latino Population (2017)		3,666	20.8%	30,913	22.1%	73,656	22.5%
Not Hispanic or Latino Population (2022)		14,807	77.3%	115,662	76.1%	269,465	75.7%
Hispanic or Latino Population (2022)		4,338	22.7%	36,307	23.9%	86,637	24.3%
Not Hispanic or Latino Population (2010)		13,676	81.5%	107,499	80.3%	248,228	79.9%
Hispanic or Latino Population (2010)		3,098	18.5%	26,429	19.7%	62,528	20.1%
Not Hispanic or Latino Population (2000)		15,891	89.3%	120,203	88.1%	276,866	87.2%
Hispanic or Latino Population (2000)		1,907	10.7%	16,274	11.9%	40,661	12.8%
Projected Hispanic Annual Growth (2017 to 2022)		672	3.7%	5,394	3.5%	12,981	3.5%
Historic Hispanic Annual Growth (2000 to 2017)		1,759	5.4%	14,639	5.3%	32,996	4.8%
<b>Age Distribution (2017)</b>							
Age Under 5		1,063	6.0%	8,764	6.3%	20,083	6.1%
Age 5 to 9 Years		1,044	5.9%	8,514	6.1%	19,716	6.0%
Age 10 to 14 Years		1,139	6.5%	9,134	6.5%	21,226	6.5%
Age 15 to 19 Years		1,206	6.8%	9,735	7.0%	22,521	6.9%
Age 20 to 24 Years		1,238	7.0%	10,217	7.3%	23,200	7.1%
Age 25 to 29 Years		1,355	7.7%	10,857	7.8%	25,285	7.7%
Age 30 to 34 Years		1,243	7.1%	10,143	7.2%	23,219	7.1%
Age 35 to 39 Years		1,103	6.3%	9,062	6.5%	20,745	6.3%
Age 40 to 44 Years		1,165	6.6%	9,189	6.6%	21,307	6.5%
Age 45 to 49 Years		1,193	6.8%	9,633	6.9%	22,536	6.9%
Age 50 to 54 Years		1,306	7.4%	9,994	7.1%	23,530	7.2%
Age 55 to 59 Years		1,308	7.4%	9,357	6.7%	22,390	6.8%
Age 60 to 64 Years		1,051	6.0%	7,759	5.5%	18,596	5.7%
Age 65 to 74 Years		1,359	7.7%	10,753	7.7%	25,867	7.9%
Age 75 to 84 Years		592	3.4%	4,978	3.6%	12,050	3.7%
Age 85 Years or Over		270	1.5%	1,936	1.4%	5,210	1.6%
Median Age		37.2		36.3		36.9	
<b>Gender Age Distribution (2017)</b>							
Female Population		8,852	50.2%	70,086	50.1%	165,505	50.5%
Age 0 to 19 Years		2,163	24.4%	17,588	25.1%	40,765	24.6%
Age 20 to 64 Years		5,457	61.6%	42,643	60.8%	100,561	60.8%
Age 65 Years or Over		1,232	13.9%	9,855	14.1%	24,178	14.6%
Female Median Age		38.3		37.5		38.2	
Male Population		8,782	49.8%	69,940	49.9%	161,977	49.5%
Age 0 to 19 Years		2,288	26.1%	18,559	26.5%	42,781	26.4%
Age 20 to 64 Years		5,505	62.7%	43,569	62.3%	100,248	61.9%
Age 65 Years or Over		989	11.3%	7,812	11.2%	18,948	11.7%
Male Median Age		36.1		35.1		35.7	

This report was produced using data from private and government sources deemed to be reliable. The information herein is provided without representation or warranty.

# EXPANDED PROFILE

2000-2010 Census, 2017 Estimates with 2022 Projections

Calculated using Weighted Block Centroid from Block Groups

Lat/Lon: 33.6397/-112.1300

RF5

## W Bell Rd & N 33rd Ave

Phoenix, AZ 85053

1 mi radius      3 mi radius      5 mi radius

### Household Income Distribution (2017)

HH Income \$200,000 or More	73	1.0%	1,567	2.9%	4,841	3.8%
HH Income \$150,000 to \$199,999	225	3.2%	2,332	4.3%	6,187	4.8%
HH Income \$100,000 to \$149,999	834	12.0%	6,826	12.5%	17,024	13.2%
HH Income \$75,000 to \$99,999	1,149	16.5%	7,852	14.4%	18,038	14.0%
HH Income \$50,000 to \$74,999	1,516	21.7%	11,314	20.7%	25,509	19.8%
HH Income \$35,000 to \$49,999	1,147	16.4%	8,728	16.0%	19,018	14.7%
HH Income \$25,000 to \$34,999	910	13.0%	5,955	10.9%	13,451	10.4%
HH Income \$15,000 to \$24,999	537	7.7%	4,996	9.1%	12,439	9.6%
HH Income Under \$15,000	591	8.5%	5,088	9.3%	12,493	9.7%
HH Income \$35,000 or More	4,945	70.8%	38,620	70.7%	90,617	70.2%
HH Income \$75,000 or More	2,282	32.7%	18,578	34.0%	46,090	35.7%

### Housing (2017)

Total Housing Units	7,185		56,612		133,767	
Housing Units Occupied	6,982	97.2%	54,659	96.5%	129,000	96.4%
Housing Units Owner-Occupied	4,297	61.5%	33,212	60.8%	77,418	60.0%
Housing Units, Renter-Occupied	2,685	38.5%	21,446	39.2%	51,582	40.0%
Housing Units, Vacant	203	2.8%	1,953	3.5%	4,768	3.6%

### Marital Status (2017)

Never Married	4,832	33.6%	38,476	33.9%	93,316	35.0%
Currently Married	5,437	37.8%	47,681	42.0%	109,388	41.1%
Separated	782	5.4%	4,855	4.3%	10,808	4.1%
Widowed	762	5.3%	5,693	5.0%	13,667	5.1%
Divorced	2,576	17.9%	16,909	14.9%	39,278	14.7%

### Household Type (2017)

Population Family	14,350	81.4%	113,022	80.7%	262,218	80.1%
Population Non-Family	3,232	18.3%	26,412	18.9%	62,464	19.1%
Population Group Quarters	52	0.3%	592	0.4%	2,800	0.9%
Family Households	4,519	64.7%	34,913	63.9%	81,580	63.2%
Non-Family Households	2,463	35.3%	19,746	36.1%	47,419	36.8%
Married Couple with Children	1,209	22.2%	10,001	21.0%	23,507	21.5%
Average Family Household Size	3.2		3.2		3.2	

### Household Size (2017)

1 Person Households	1,856	26.6%	14,728	26.9%	35,917	27.8%
2 Person Households	2,382	34.1%	17,749	32.5%	42,383	32.9%
3 Person Households	1,181	16.9%	9,392	17.2%	21,319	16.5%
4 Person Households	860	12.3%	6,798	12.4%	15,881	12.3%
5 Person Households	402	5.8%	3,483	6.4%	7,897	6.1%
6 or More Person Households	301	4.3%	2,510	4.6%	5,602	4.3%

### Household Vehicles (2017)

Households with 0 Vehicles Available	383	5.5%	3,098	5.7%	7,473	5.8%
Households with 1 Vehicles Available	2,692	38.6%	21,084	38.6%	48,375	37.5%
Households with 2 or More Vehicles Available	3,906	55.9%	30,477	55.8%	73,152	56.7%
Total Vehicles Available	12,249		95,413		226,035	
Average Vehicles Per Household	1.8		1.7		1.8	

This report was produced using data from private and government sources deemed to be reliable. The information herein is provided without representation or warranty.

# EXPANDED PROFILE

2000-2010 Census, 2017 Estimates with 2022 Projections

Calculated using Weighted Block Centroid from Block Groups

Lat/Lon: 33.6397/-112.1300

RF5

## W Bell Rd & N 33rd Ave

Phoenix, AZ 85053

1 mi radius      3 mi radius      5 mi radius

### Labor Force (2017)

Estimated Labor Population Age 16 Years or Over	14,158		111,823		262,281
Estimated Civilian Employed	9,051	63.9%	70,842	63.4%	164,775
Estimated Civilian Unemployed	438	3.1%	3,709	3.3%	8,521
Estimated in Armed Forces	22	0.2%	98	0.1%	174
Estimated Not in Labor Force	4,647	32.8%	37,175	33.2%	88,811
Unemployment Rate	3.1%		3.3%		3.2%

### Occupation (2015)

Occupation: Population Age 16 Years or Over	9,060		70,973		164,818
Management, Business, Financial Operations	1,405	15.5%	10,698	15.1%	24,223
Professional, Related	1,536	17.0%	12,912	18.2%	31,793
Service	1,510	16.7%	12,427	17.5%	30,743
Sales, Office	2,938	32.4%	21,181	29.8%	47,862
Farming, Fishing, Forestry	9	0.1%	131	0.2%	375
Construct, Extraction, Maintenance	853	9.4%	6,643	9.4%	14,052
Production, Transport Material Moving	809	8.9%	6,983	9.8%	15,770
White Collar Workers	5,879	64.9%	44,790	63.1%	103,878
Blue Collar Workers	3,181	35.1%	26,183	36.9%	60,940

### Consumer Expenditure (2017)

Total Household Expenditure	\$343 M		\$2.85 B		\$6.95 B
Total Non-Retail Expenditure	\$186 M	54.2%	\$1.55 B	54.2%	\$3.77 B
Total Retail Expenditure	\$157 M	45.8%	\$1.30 B	45.8%	\$3.18 B
Apparel	\$11.9 M	3.5%	\$99.4 M	3.5%	\$243 M
Contributions	\$13.6 M	4.0%	\$118 M	4.1%	\$295 M
Education	\$11.4 M	3.3%	\$99.9 M	3.5%	\$250 M
Entertainment	\$19.2 M	5.6%	\$159 M	5.6%	\$390 M
Food and Beverages	\$51.3 M	14.9%	\$423 M	14.8%	\$1.03 B
Furnishings and Equipment	\$11.7 M	3.4%	\$97.2 M	3.4%	\$238 M
Gifts	\$7.96 M	2.3%	\$68.1 M	2.4%	\$169 M
Health Care	\$28.3 M	8.2%	\$231 M	8.1%	\$560 M
Household Operations	\$9.30 M	2.7%	\$79.1 M	2.8%	\$196 M
Miscellaneous Expenses	\$5.16 M	1.5%	\$42.5 M	1.5%	\$103 M
Personal Care	\$4.49 M	1.3%	\$37.1 M	1.3%	\$90.4 M
Personal Insurance	\$2.39 M	0.7%	\$20.5 M	0.7%	\$50.7 M
Reading	\$759 K	0.2%	\$6.31 M	0.2%	\$15.4 M
Shelter	\$70.1 M	20.4%	\$584 M	20.5%	\$1.43 B
Tobacco	\$2.26 M	0.7%	\$18.2 M	0.6%	\$43.5 M
Transportation	\$66.9 M	19.5%	\$548 M	19.2%	\$1.33 B
Utilities	\$26.6 M	7.8%	\$218 M	7.7%	\$528 M

### Educational Attainment (2017)

Adult Population Age 25 Years or Over	11,945		93,662		220,736
Elementary (Grade Level 0 to 8)	317	2.7%	3,691	3.9%	8,422
Some High School (Grade Level 9 to 11)	849	7.1%	6,701	7.2%	16,189
High School Graduate	3,541	29.6%	25,469	27.2%	57,556
Some College	3,563	29.8%	26,775	28.6%	60,846
Associate Degree Only	981	8.2%	8,448	9.0%	19,753
Bachelor Degree Only	1,997	16.7%	15,314	16.4%	38,421
Graduate Degree	698	5.8%	7,264	7.8%	19,548

This report was produced using data from private and government sources deemed to be reliable. The information herein is provided without representation or warranty.

# EXPANDED PROFILE

2000-2010 Census, 2017 Estimates with 2022 Projections

Calculated using Weighted Block Centroid from Block Groups

Lat/Lon: 33.6397/-112.1300

RF5

## W Bell Rd & N 33rd Ave

Phoenix, AZ 85053

### Units In Structure (2015)

	1 mi radius		3 mi radius		5 mi radius	
1 Detached Unit	4,861	74.5%	37,086	72.0%	85,698	71.2%
1 Attached Unit	302	4.6%	2,099	4.1%	4,592	3.8%
2 to 4 Units	224	3.4%	2,434	4.7%	5,906	4.9%
5 to 9 Units	486	7.5%	3,400	6.6%	7,509	6.2%
10 to 19 Units	525	8.0%	4,507	8.7%	10,392	8.6%
20 to 49 Units	136	2.1%	1,208	2.3%	3,568	3.0%
50 or More Units	321	4.9%	1,956	3.8%	6,077	5.0%
Mobile Home or Trailer	128	2.0%	1,976	3.8%	5,113	4.2%
Other Structure	4	0.1%	94	0.2%	190	0.2%

### Homes Built By Year (2015)

Homes Built 2010 or later	36	0.5%	271	0.5%	670	0.6%
Homes Built 2000 to 2009	477	7.3%	5,148	10.0%	12,728	10.6%
Homes Built 1990 to 1999	1,115	17.1%	10,847	21.1%	28,441	23.6%
Homes Built 1980 to 1989	2,265	34.7%	14,469	28.1%	35,127	29.2%
Homes Built 1970 to 1979	2,584	39.6%	17,358	33.7%	36,371	30.2%
Homes Built 1960 to 1969	250	3.8%	4,069	7.9%	9,147	7.6%
Homes Built 1950 to 1959	111	1.7%	1,388	2.7%	3,378	2.8%
Homes Built Before 1949	42	0.6%	352	0.7%	1,000	0.8%

### Home Values (2015)

Home Values \$1,000,000 or More	25	0.6%	201	0.6%	544	0.7%
Home Values \$500,000 to \$999,999	192	4.6%	1,657	5.2%	4,060	5.4%
Home Values \$400,000 to \$499,999	133	3.2%	1,209	3.8%	3,437	4.6%
Home Values \$300,000 to \$399,999	342	8.3%	3,246	10.1%	9,374	12.5%
Home Values \$200,000 to \$299,999	863	20.8%	7,430	23.1%	18,239	24.3%
Home Values \$150,000 to \$199,999	1,159	27.9%	7,493	23.3%	16,373	21.8%
Home Values \$100,000 to \$149,999	972	23.4%	6,927	21.6%	14,291	19.0%
Home Values \$70,000 to \$99,999	384	9.3%	2,659	8.3%	5,343	7.1%
Home Values \$50,000 to \$69,999	57	1.4%	832	2.6%	1,691	2.3%
Home Values \$25,000 to \$49,999	42	1.0%	373	1.2%	1,096	1.5%
Home Values Under \$25,000	120	2.9%	1,087	3.4%	2,665	3.6%
Owner-Occupied Median Home Value	\$172,337		\$181,231		\$196,825	
Renter-Occupied Median Rent	\$781		\$808		\$809	

### Transportation To Work (2015)

Drive to Work Alone	6,510	78.1%	51,118	77.5%	119,474	77.6%
Drive to Work in Carpool	744	8.9%	6,713	10.2%	15,261	9.9%
Travel to Work by Public Transportation	357	4.3%	1,970	3.0%	4,411	2.9%
Drive to Work on Motorcycle	42	0.5%	365	0.6%	835	0.5%
Walk or Bicycle to Work	282	3.4%	1,940	2.9%	4,219	2.7%
Other Means	57	0.7%	624	0.9%	1,887	1.2%
Work at Home	342	4.1%	3,232	4.9%	7,955	5.2%

### Travel Time (2015)

Travel to Work in 14 Minutes or Less	1,839	23.0%	16,726	26.7%	34,326	23.5%
Travel to Work in 15 to 29 Minutes	3,605	45.1%	26,470	42.2%	63,561	43.5%
Travel to Work in 30 to 59 Minutes	2,754	34.5%	20,730	33.0%	50,039	34.3%
Travel to Work in 60 Minutes or More	497	6.2%	3,605	5.7%	8,346	5.7%
Average Minutes Travel to Work	22.9		22.5		23.3	

This report was produced using data from private and government sources deemed to be reliable. The information herein is provided without representation or warranty.